

During initial setup, Please connect **Android Auto Once!**

- * You need to connect once after the update.
- * This is required for calls and voice output in your car.

No Wi-Fi password needed! Just
connect AutoProX_0000 via Bluetooth!

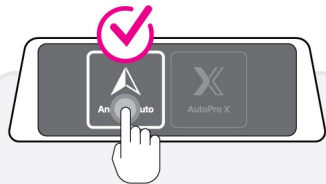

On the AutoPro X navigation
screen, select Android Auto
mode on the left, then find and
connect to AutoProX_0000 in
your phone's Bluetooth settings.

Online Manual

Learn how to use AutoPro X easily with the online manual!

- * Scan with your phone and tap the link.

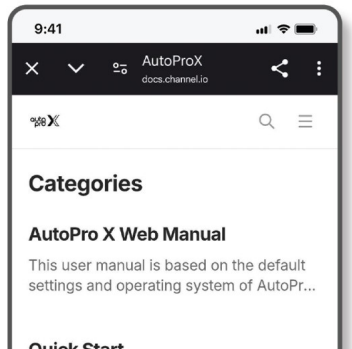

Video Guide

Watch the video to learn how to use AutoPro X easily!

- * Scan with your phone and tap the link.

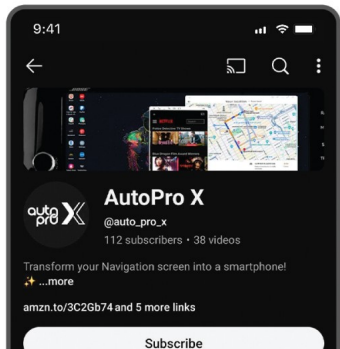

Install AutoPro X app

For smooth usage and firmware updates, please make sure to install it.

- * Scan with your phone and tap the link.

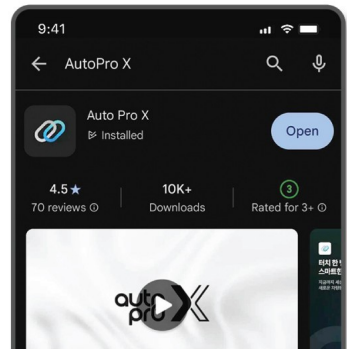

One-on-one customer service

Contact us anytime if you have any issues!

- * Scan with your phone and tap the link.

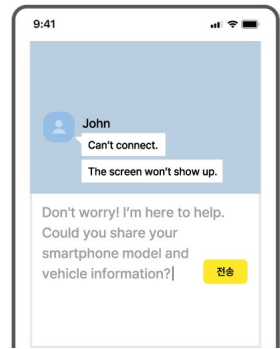

For "Wireless" Android Auto cars, Please Turn this mode on!

It disables the car's wireless Android Auto and connects through AutoPro X instead. Just set it up once in the app.



See if your car brand is listed!



Scan the QR code below and follow the video guide to enable GM mode only if the connection fails.

* !Please update while plugged into the charging port.

- 1 Install the AutoPro X app and connect the device.
- 2 Tap the top-right gear icon.
- 3 Choose "Specific Vehicle Setting"
- 4 Tap your vehicle.



See if your car brand is listed!



For Toyota/Lexus cars, scan the QR code and properly use the black cable.
(For vehicles with a C port, contact us via Messenger.)

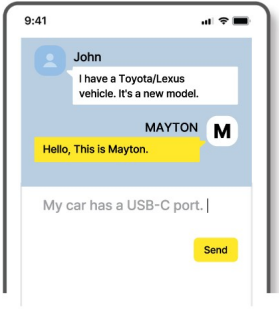

FAQ

Q. Calls are received on my phone.

A. You need to connect Android Auto through AutoPro X once during the initial setup.

Q. The keyboard does not appear.

A. On the navigation screen, go to Settings > Samsung DeX > Keyboard > Enable "Show on-screen keyboard in Samsung DeX."

Q. How can I make the screen and text bigger?

A. On the navigation screen, Settings > Samsung DeX > Font Size and Screen Zoom

Q. How can I adjust Netflix to full screen?

A. On your phone, go to Settings > Advanced Features > Labs > Enable "Multi-window for all apps."

Q. What is the Wi-Fi password?

A. AutoPro X connects easily without a Wi-Fi password. Please refer to the user manual for more details.

* For wireless Android Auto cars, see the manual.



Please check!



AutoPro X

